

**TECHNICAL DATA SHEET**

**SemDrain® drainage channel**

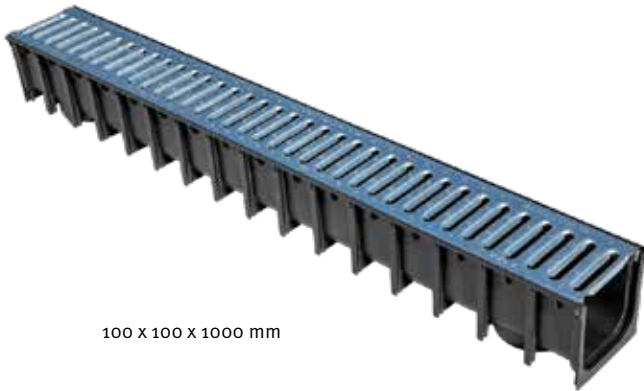



**DIY A15 Galvanized Steel Grid, plastic edge**



100 X 100 X 1000 mm



<b>Appearance</b>	<p><b>Grid:</b> Galvanized Steel Grid  <b>Edges:</b> plastic edges  <b>Laying:</b> manual</p>
<b>Product features</b>	<ul style="list-style-type: none"> <li>• Material: polypropylene with excellent mechanical, physical and chemical properties</li> <li>• Resistance to high temperatures, salts, acids and alkalis</li> <li>• Small weight, high stiffness</li> <li>• Male/female embedding system with preinstalled grids</li> <li>• Easy access to the channel - easy to clean</li> </ul>
<b>Application</b>	<p>Areas which can only be used by pedestrians and pedal cyclists, as well as similar surfaces such as green areas, garden areas, school yards.</p>

Technical specifications					
Class load A15		Load strenght 15 kN	Weight load 1500 kg		
<b>Dimensions mm</b>			Weight kg/pc	Quantity pcs/pal	Weight kg/pal
L X H	L1 X H1	2,4	80	192	
100 X 50	125 X 117				

Laying		Surface load capacity		
Manual	Machine laying	pedestrians	automobile	truck
X		X		

**TECHNICAL DATA SHEET**

**SemDrain® drainage channel**



PP drainage channel  
Plastic edge

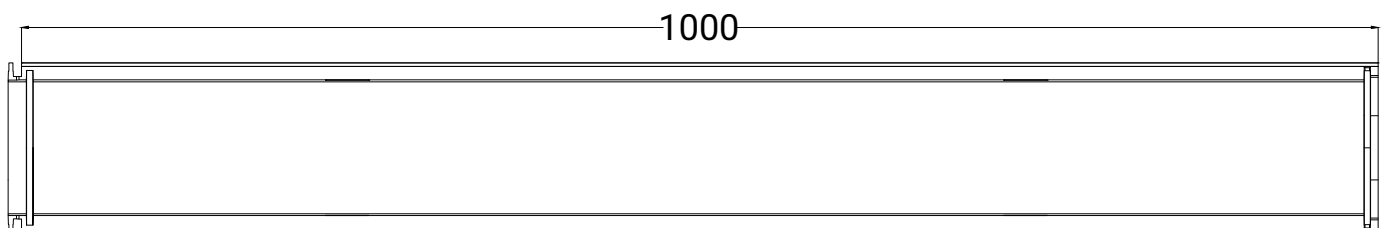
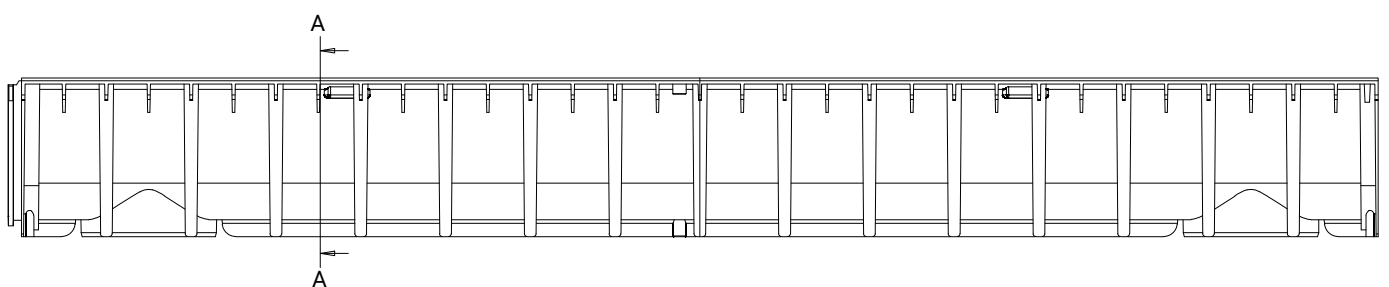
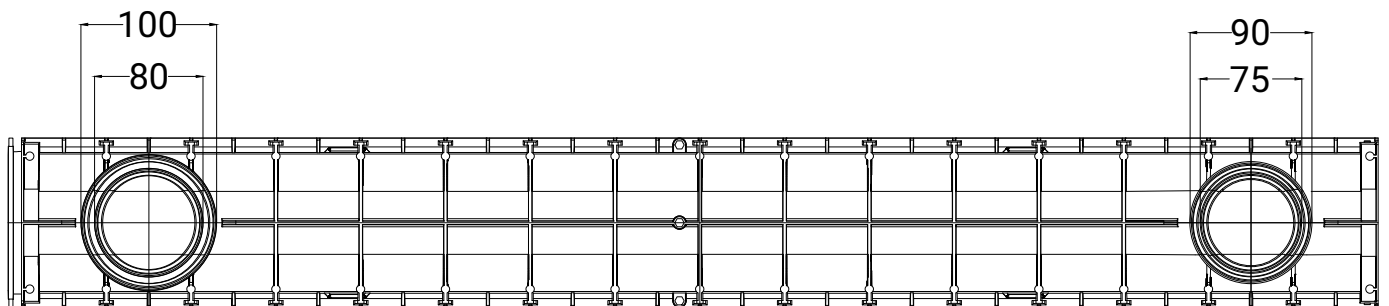
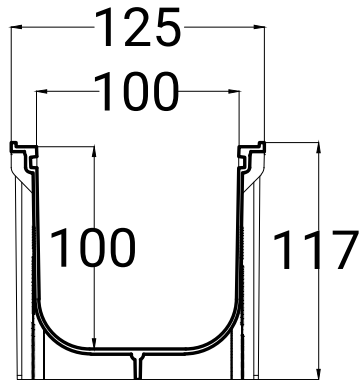

Laying		Surface load capacity		
Manual	Machine laying	pedestrians	automobile	truck
X		X		

**TECHNICAL DATA SHEET**

**SemDrain® drainage channel**



**Galvanized Steel Grid**  
**Drain: 260 cm<sup>2</sup>/m**  
**Weight: 1,2 kg/m**

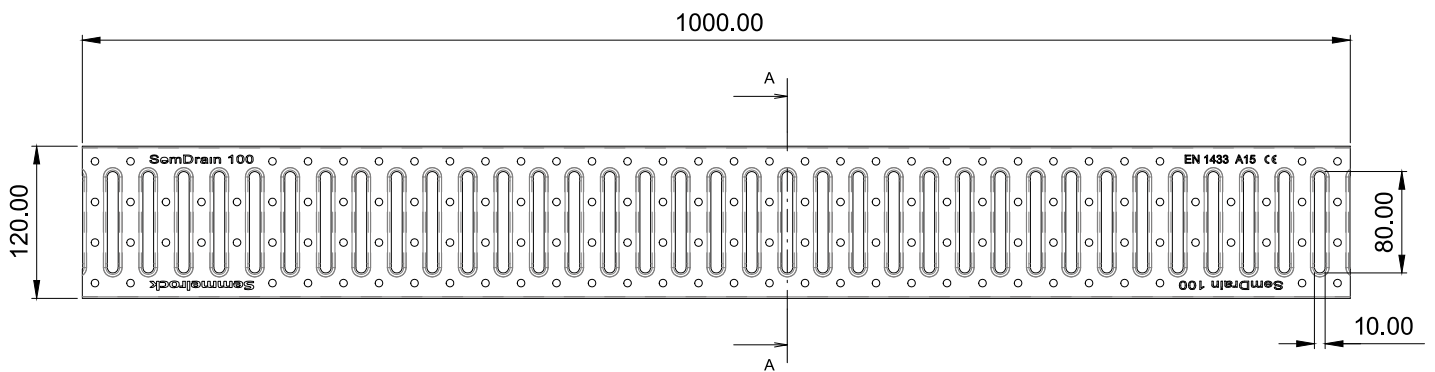
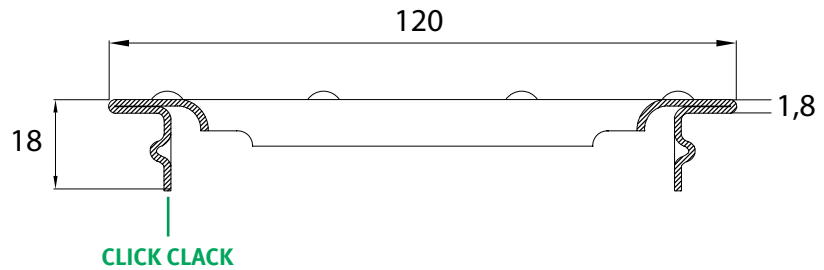

**Accessories**

**DIY Blank end-plugs**

**SemDrain four-way connector**

**Enlarging piece Ø 90-100/110**



For additional information, take a look at Accessories technical data sheet.

Laying		Surface load capacity		
Manual	Machine laying	pedestrians	automobile	truck
X		X		